

# This Week at a Glance

Events and meetings are held here at Calvary Chapel unless otherwise noted

## Sunday

**Worship Services | 9:00 AM & 10:45 AM**

Nursery-Elementary Bible classes are provided

**Oasis Youth Group | 10:45 AM**

6th-12th grade meets at Youth bldg. after worship

## Monday

**Trail Life Meeting | 6:30PM – 8:00PM**

## Tuesday

**Men's Breakfast & Study | 6:30–7:30 AM**

Study & breakfast in Lobby

**Adult Focus Group | 6:30–8:00 PM**

Dean Wilson 590-7017 (Hosted at Terry Gray's house)

**Women's Bible Study | 6:30–8:00 PM**

At Debbie Peterman's house, 832-2010

## Wednesday

**Prayer | 6:30 AM**

**Worship, Prayer & Fellowship | 6:30–8:00 PM**

Acts 2:42 Fellowship. Childcare provided

**Oasis Youth Group | 6:30–8:00 PM**

6th-12th grade meets at Youth bldg. after worship

## Thursday

**Women's College Age Bible Study | 7:00–8:00 PM**

Contact Kim Davis, 412-1930

## Saturday

**Men's Group | 7:00–8:00 AM**

Meets at Youth bldg. across the street

# Highlights

For more info on upcoming events visit: [www.ccmountainhome.com](http://www.ccmountainhome.com)

WORSHIP • PRAYER • FELLOWSHIP  
**ACTS 2:42**  
 "AND THEY CONTINUED STEADFASTLY IN THE APOSTLES' DOCTRINE AND FELLOWSHIP, IN THE BREAKING OF BREAD, AND IN PRAYERS."  
**JULY 8TH | 6:30 PM**

**Church Picnic**  
 Sun. July 19<sup>th</sup>, 5pm  
 Richard Aguirre Park

**Men's Breakfast & Study**  
 Tuesday Mornings  
 6:30-7:30a, In the Lobby

**GET INVOLVED**  
 Sign up on a Response card

# Pastor's Perspective

*And thus you shall eat it: with a belt on your waist, your sandals on your feet, and your staff in your hand. So you shall eat it in haste. It is the Lord's Passover." Exodus 12:11*

For many years the children of Israel had been held down by the hand of the Egyptians; forced into hard labor and times of poverty. Their hope was waning as they cried to God, "Help! Oh God please help". It is when we have exhausted all options that we cry to God with the greatest fervency. In hard times there is opportunity to simplify and clarify. We simplify by reviewing what we are doing and then letting go of the things that have made us weak, ineffective and out of focus. As we reduce the clutter we gain clarity, focusing on what is important to us. As we turn to Him we begin to see that He meets us where we are and then draws us close to Him.

The children of Israel had cried out to God and now they were told to get ready, for God was drawing them close to Him. They were not to be sitting down and settling in with the world around them but they were to be ready when He said, "Come close to Me"! Are we willing when God says, "Draw near to Me, It is time for change." When He prompts will we respond promptly? In the days of difficulty be encouraged, draw near to Him. Be ready, draw near to Him and rest assured, *"being confident of this very thing, that He who has begun a good work in you will complete it until the day of Jesus Christ"* (Philippians 1:6)

Grace be with you,

**WELCOME!** IN ORDER FOR US TO GET TO KNOW YOU PLEASE COMPLETE THIS CARD AND DROP IT IN AN OFFERING BOX.

**Thank you for worshipping with us!**  
 We would love to get your current information to keep you connected!

Date \_\_\_\_\_  First Time Visitor  Address Change  Please Contact Me

Mr. \_\_\_\_\_ Mobile \_\_\_\_\_

Email \_\_\_\_\_

Mrs./Ms. \_\_\_\_\_ Mobile \_\_\_\_\_

Email \_\_\_\_\_

Home Address \_\_\_\_\_

City, State, and Zip \_\_\_\_\_

Child \_\_\_\_\_ DoB \_\_\_\_\_

Child \_\_\_\_\_ DoB \_\_\_\_\_

Child \_\_\_\_\_ DoB \_\_\_\_\_

## CHILDREN: Nursery, Preschool & Elementary

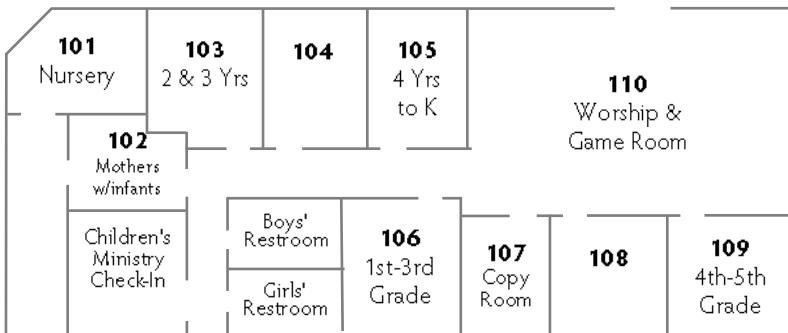

## YOUTH BUILDING ACROSS THE STREET

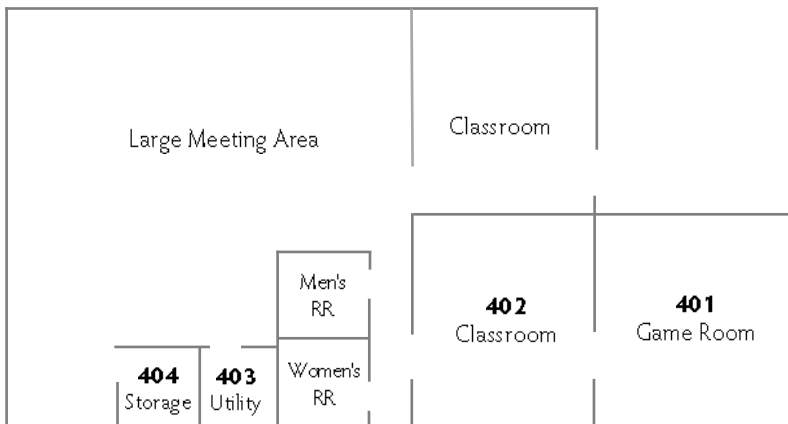

### Find Like Information on:

#### Personal Living/Growth:

How to begin a relationship with Christ

How to grow spiritually

Water Baptism

Baby Dedication

#### FOCUS Groups:

Adult Groups

Men's Groups

Women's Groups

Jr & Sr High Youth Groups

#### Outreach:

Local

Overseas Missions

### Opportunities to Serve:

Wherever Needed

Children's Ministry

Mops Ministry

Men's Ministry

Women's Ministry

Jr & Sr High Youth Groups

Children's Ministry

American Heritage Girls

Trail Life

Worship Ministry

Sound Ministry

Ushers & Greeters

Church Maintenance

Church Office Help

Church Cleaning Team

Operation Homefront

Response, Comments & Prayer Requests:

---



---



---

## VISITOR INFORMATION

We're committed to bless your worship experience during services:

- **Please be aware that our main parking lot is for family use in order to eliminate the risk of children crossing the busy street.**
- Nursery, Preschool, and Elementary Bible classes are provided during services. Please check your children in at the Children's Ministry check-in desk
- **Back row chairs are reserved for families with young children. Please be considerate of others; if your children are in anyway distracting or restless you will be asked to step out into the lobby and/or check into Children's Ministry Classes.**
- A closed circuit television is located in the Mothers with Infants room
- Please silence your cell phone
- Lost & Found is located at the Children's Ministry check-in desk
- Offering boxes and response cards are located near the entrances to the Sanctuary

### STAY CONNECTED



Pastor Dan Davis

208-580-0662 | 350 N Main St.

Our Statement of Faith can be found on our website

[www.ccmountainhome.com](http://www.ccmountainhome.com) | [office@ccmountainhome.com](mailto:office@ccmountainhome.com)



**Calvary Chapel**  
Mountain Home

WEEKLY BULLETIN

July 5th - 11th